

Elmar Slickline Pressure Control Equipment Rig Up

You'll benefit from safe operations and low cost of ownership with long asset life when using Elmar™ slickline well pressure control equipment. Easy to rig up, reliable, and with minimum maintenance requirements, our WPCE will keep your slickline operations running for many years to come.

A full range of slickline pressure control equipment is available including wellhead adapters, wireline valves, lubricators, stuffing boxes, and more. Specifications vary from the basic 2½-in. ID 5,000-psi working pressure string with a manual wireline valve, through to 20,000-psi working pressure strings with triple and quad hydraulically operated wireline valves, up to 9-in. through bore.

Our equipment is designed with attention to detail and manufactured with care, providing you with equipment that is simple and fast to rig up, and comes with quality and reliability as standard.



Your slickline pressure control equipment is fully traceable and certified by independent authorities, giving you the confidence you need under pressure. We provide access to your certification worldwide and around the clock, keeping operations moving wherever you are in the world.

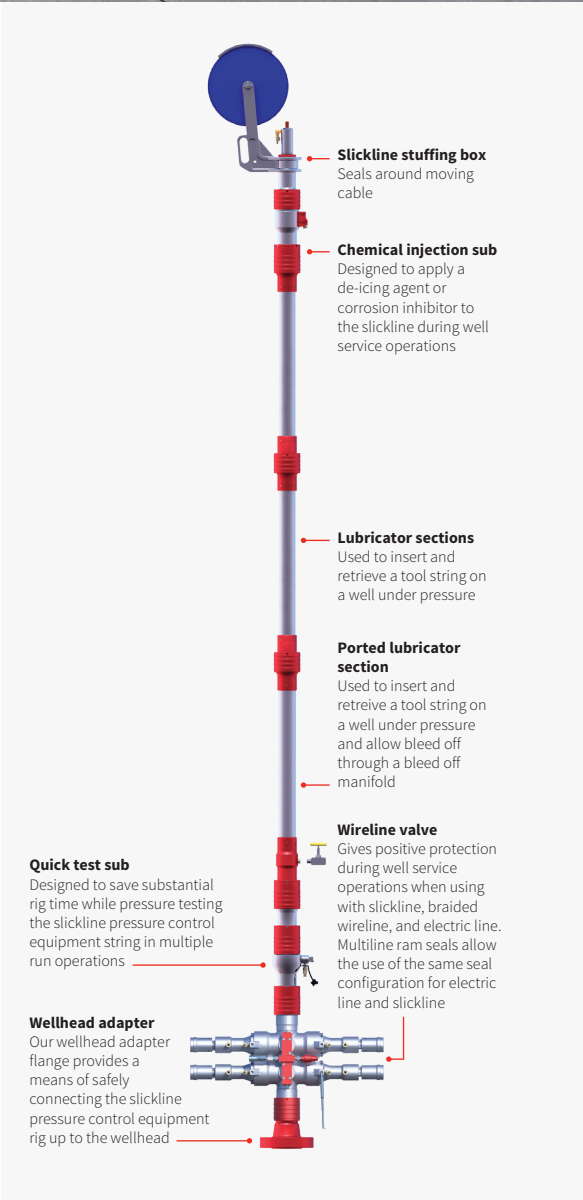

Typical Elmar Slickline Pressure Control Rig-Up

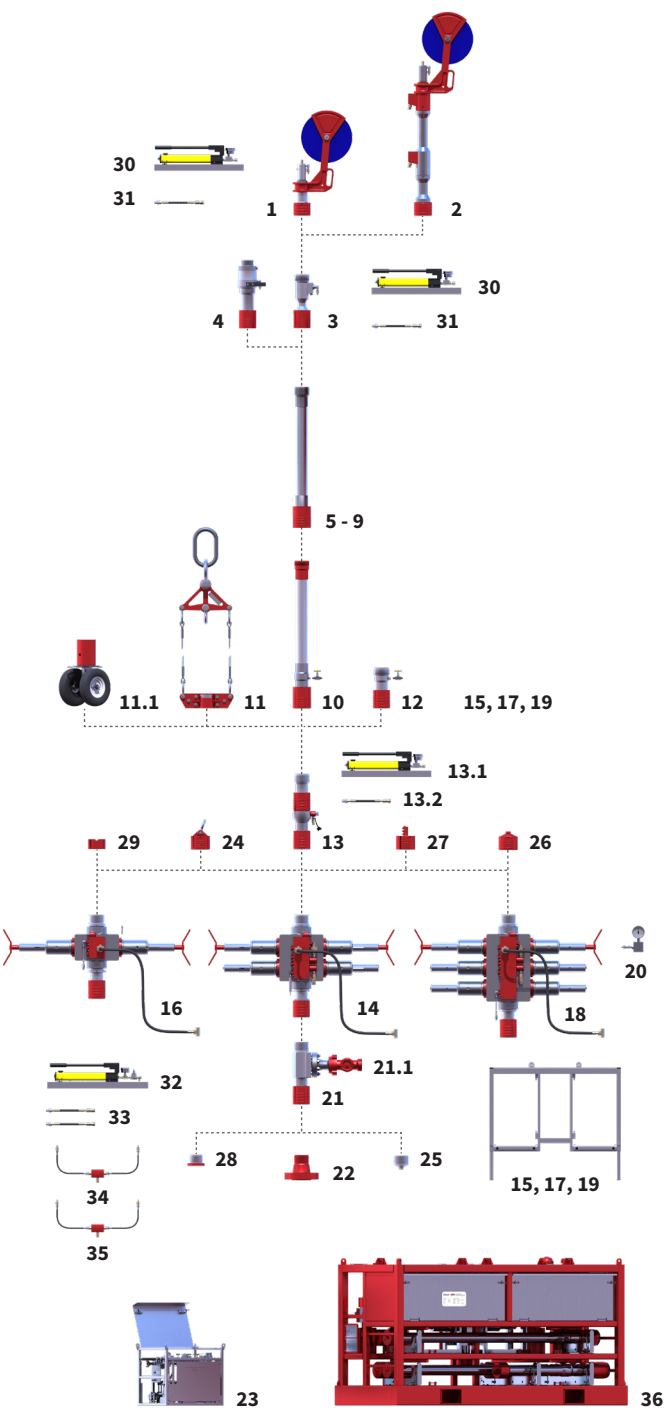

*Not required when control module is purchased. Equipment supplied with thread protectors. Wire size to be specified when ordering.

Item	Description
1	Hydraulic slickline stuffing box with sheave wheel
2	Liquid seal slickline control head
3	Chemical injection sub
4	Hydraulic tool catcher
5	Lubricator section with quick unions, 4-ft long
6	Lubricator section with quick unions, 5-ft long
7	Lubricator section with quick unions, 6-ft long
8	Lubricator section with quick unions, 8-ft long
9	Lubricator section with quick unions, 10-ft long
10	Lower lubricator section with bleed-down port
11	Lubricator lifting clamp, spreader beam, and wire rope slings
11.1	Lubricator dolly with quick union
12	Bleed-off sub
13	Quick test sub
13.1	Hand pump assembly for quick test sub
13.2	Hose assembly ¼ in. x 25-ft long with quick connections
14	Dual hydraulic wireline valve
15	Galvanized dual wireline valve cage
16	Single hydraulic wireline valve
17	Galvanized single wireline valve cage
18	Triple hydraulic wireline valve
19	Galvanized triple wireline valve cage
20	Wireline valve manifold gauge
21	Pump-in sub with (1) 2-in.-1502 side outlet
21.1	Plug valve 2-in.-1502 Weco male x female
22	Wellhead adapter flange
23	Hydraulic actuator for stuffing box, tool catcher, and wireline valve*
24	Lifting bail
25	Test cap/stump
26	Test plug and collar
27	Safety flow diverter valve and wire clamp
28	Male thread protector (spare)
29	Female thread protector (spare)
30	Line wiper, stuffing box, or tool catcher hand pump*
31	Hydraulic hose ¼ in. x 100-ft long with quick couplings
32	Wireline valve hand pump*
33	Hydraulic hose ¼ in. x 50-ft long with quick couplings
34	"Y" hose, wireline valve open
35	"Y" hose, wireline valve close
36	Transport frame

